

**mimono**

User Manual | English

For more information visit our website:  
**[www.mimono.com](http://www.mimono.com)**



**mimono**

# Table of Contents

Index	-----	1
Introduction	-----	2 - 3
Quick Start Guide 4	-----	4
Safety Precautions 5	-----	5
Product Overview/ LED Indicator 6	-----	6
On-Screen Display Function Key 7	-----	7
On-Screen Display Main Sub Menu Settings 8	-----	8
Built in Battery 9	-----	9
Battery Capacity Indicator 10	-----	10
Specifications 11	-----	11
Troubleshooting 12	-----	12
Maintenance and Precautions 13	-----	13

For more information visit our website:

**[www.mimono.com](http://www.mimono.com)**



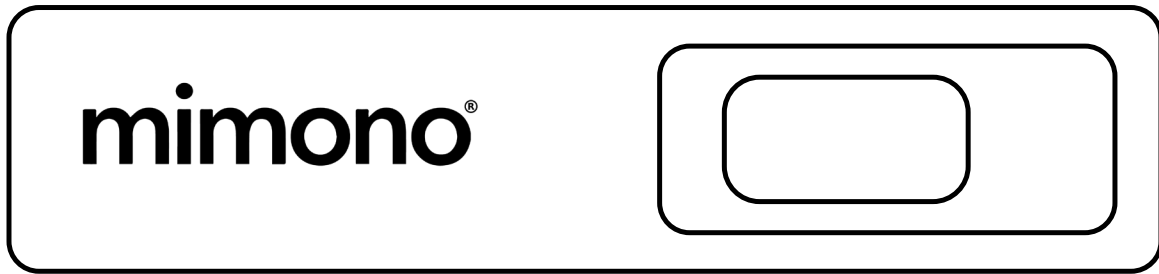

## Introduction

Mimono is a portable laser projector with a super soft silicone encasement and 4 hour battery. Mimono has four legs and a tail that are completely bendable 360 degrees for placement on many surfaces and areas. Our achievement is quick connectivity and hands free operation of this simple little lovable projector. It's portability and power of projection make it a comfortable friend to take along everywhere.

Mimono portable laser projector allows you to move thru different environments without losing signal or having to switch networks, mimono does not need networks, apps or wifi to connect. Mimono only needs it's hdmi cable and ready. Friendlies projector ever! Project mimono happily everywhere and instantly.

Appreciate mimono's high color 5 tube technology Full HD 1080p image and 120 lumens to the eye. Mimono is designed for video and movie projection on almost any surface without the need of a flat screen. Take it on your next trip and watch it's potential.

Mimono's love at first sight, will allow you to fall in love with projectors for the first time. Mimono connects so quickly, all you have to do is smile! Fall in love and enjoy mimono anywhere. It is simple and friendly. Mimono is a on the go laser projector, take your mimono and use it outdoors, use it in the car, use it on the boat, use it camping in the tent. Make your zoom meetings bigger while your camera is still working! Use it while at the beach at night on a towel, on a white sheet, on a hotel blanket, on the curtains. Take it on your next roadtrip. Go outside your house and project on your house. Relax at a rest area and project on the ceiling of the car. Also all white ceilings are great for projecting. Now you can project everywhere you go! Take your monkey anywhere! Mimono prefers being out of the office and in low light environments for full appreciation of the full spectrum of colors it has to offer.

Like all laser mems scanning projectors, mimono continuously has moving lasers making it perfect for enjoying every video in the best colors and sharpness possible. High resolution, automatic screen flip and automatic screen corrector make mimono adjust to your environment automatically hands free.

For more information visit our website:

[www.mimono.com](http://www.mimono.com)

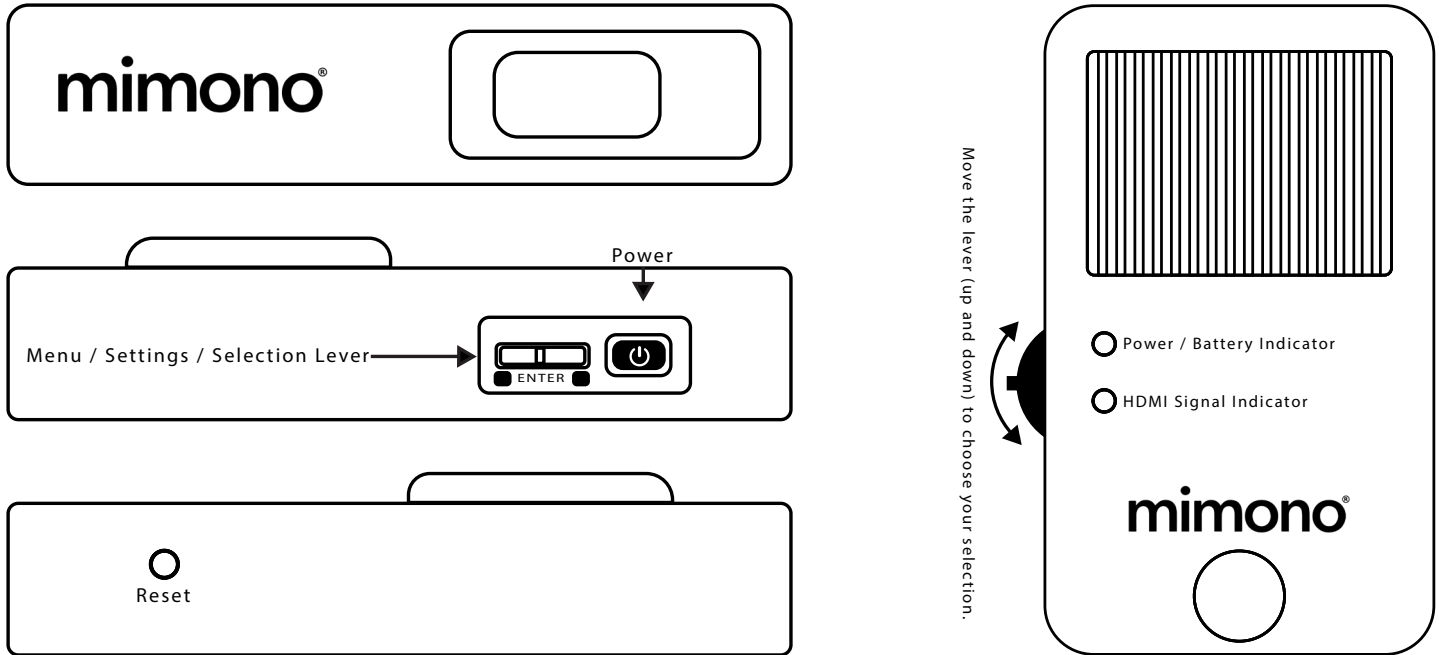

Remember, mimono is a top of the line leading laser mini projector so it's mostly recommended for movies, videos streaming and gaming and least recommended for power point presentations, or any software of this nature. Texts on karaoke videos works perfect. Mimono is a media projector for all kinds of photos, videos of any type, gaming and screen mirroring of any video content available for projection.

Connectivity is simplest with mobile devices, most computers with a media output, tablets, iPads, iPhones and many others. Mimono can also connect to apple tv, fire stick, roku, chrome cast and other non audio controlled units, with the help of a (hdmi audio extractor) or else it will project video only.

With mimono's micro size laser projecting technology mimono has 120 to the eye lumens and the best colors on the market thanks to it's additional tubes of color.

Mimono speaker-less technology leaves the audio in your media device for you to control where you want your sound to come from. Mimono is too small to have a big speaker. So mimono allows you to choose the blue-tooth speaker of your choice and enjoy your video as loud as you enjoy it.

When you want to be quiet, you can! Mimono has a silent system with it's patented fan-less technology makes it 100% silent. Mimono's patented heat dissipation allows for it to keep cool endlessly and continuously without interruptions.

Mimono monkey shape can be placed almost anywhere! Mimono has patented bendable legs, and tail, you can grip mimono onto almost anything, like a monkey. Take your new mimono laser viewer anywhere. It's time to realize you have a bigger screen now. Get out there and show the world your new little friend.

For more information visit our website:

[www.mimono.com](http://www.mimono.com)



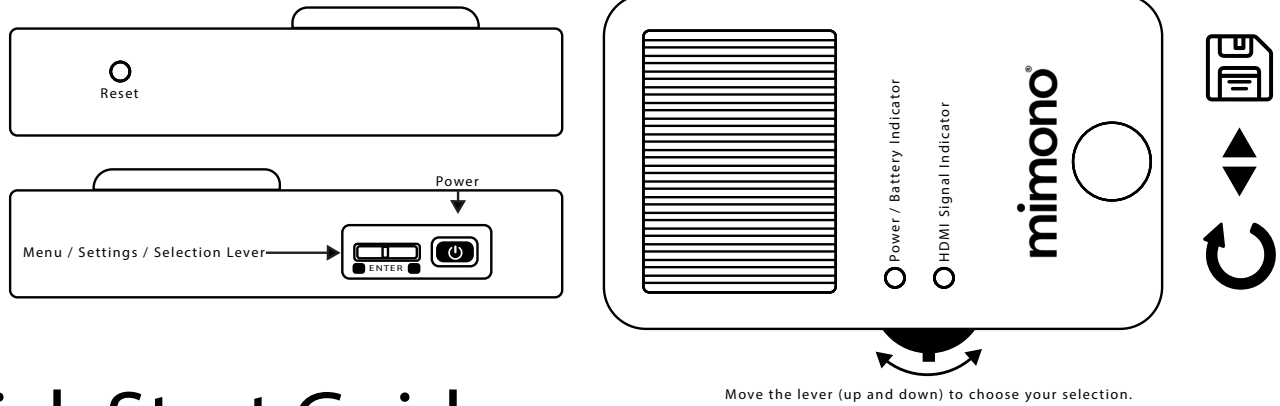

# Quick Start Guide

**Thank you for purchasing mimono, you now own the friendliest lifestyle laser projector in the world**

Mimono holds 5 very sensitive lasers and when changing altitude, because of the atmospheric pressure the sharpness might have to be adjusted.

1. Turn on/off press the power button for 4 seconds, until the light turns on. (Power button located on the left side of the unit.) Logo of mimono should be projected.
2. If image is not sharp, then follow steps 3 to 6. If the image is perfect continue to step 6.
3. Press the menu lever in towards the projector to activate the on screen menu. (Located on the left side of the projector next to the power button.)
4. With the lever move the attention to sharpness, and press the lever in towards the projector to select the sharpness option.
5. With the lever, move to the arrows, and click on the arrow that makes the screen sharper.
6. Once you achieve the perfect sharpness, with the lever move down to the floppy disk icon, and press the lever in towards the projector to save the adjustment.
7. Connect the HDMI cable into the projectors rear and connect to your media device. And start enjoying mimono.
8. Remember mimono has a smart battery, therefore if no connection is done within 1 minute, then the projector will shut down to save it's battery power.

**This adjustment should only be done once at initial setup, and when changing altitude**

## iPhone

When using an iphone, please follow the next instructions to activate the use of accesories, which will allow your HDMI converter to work with your phone:

**Settings > faceid and passcodes > scroll all the way down > Switch accessories on**

**IMPORTANT:**

If at any moment mimono does not perform as expected, just press the reset button on the side of body and reset mimono

For more information visit our website:

**www.mimono.com**



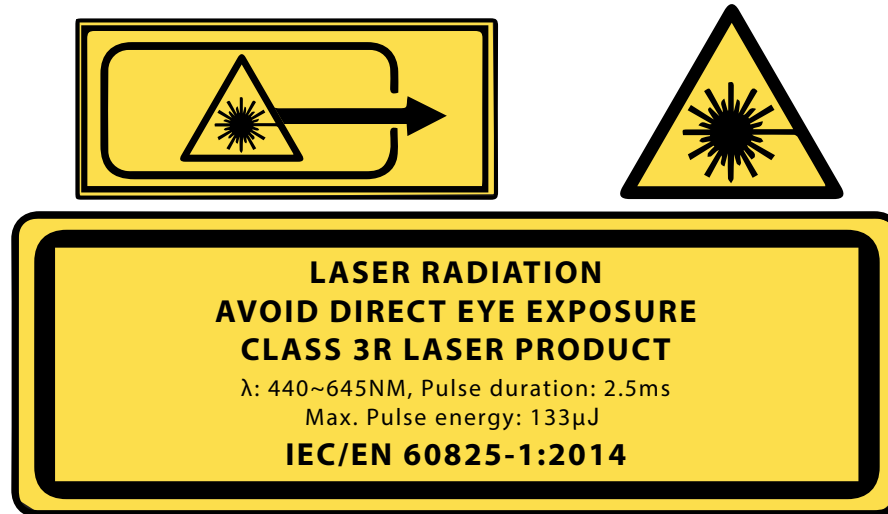

**MODEL GENERATION 1**  
Lifestyle Laser Projector  
Laser Scanning 1280 x 720 HD  
Model No: HD504MI-H4  
Battery: 4000mAh DC 5v/2.5A  
Operating Temperature 0 C to 35 C (32 F to 95 F)

## Safety Precautions

Please read all Safety Precautions before using this projector.

- Do not use the projector outside this temperature range (34-95 F)(2-35C). This could lead to damage
- If smoke, noise or odor come out of the projector, please contact Mimono Service Center:  
[www.mimono.com](http://www.mimono.com) / [support@mimono.com](mailto:support@mimono.com)
- Avoid looking directly at the projector laser beam when on. This may cause damage to the eyes.
- Keep the projector out of the reach of infants and young children
- When not in use, place projector in well ventilated dry area
- Do not place liquids on or near projector
- Do not place any objects on the projector or near the lens
- Do not attempt to disassemble or open the projector. Mimono's guarantee does not cover tampered projectors
- Do not place the projector in or near sunlight or other heat sources
- Do not drop or throw the projector

**Note:** Press the power switch for 4 seconds to power on. If not connected to a source it will power off automatically after 1 minute. Children are required adult supervision while using the projector.

For more information visit our website:

[www.mimono.com](http://www.mimono.com)

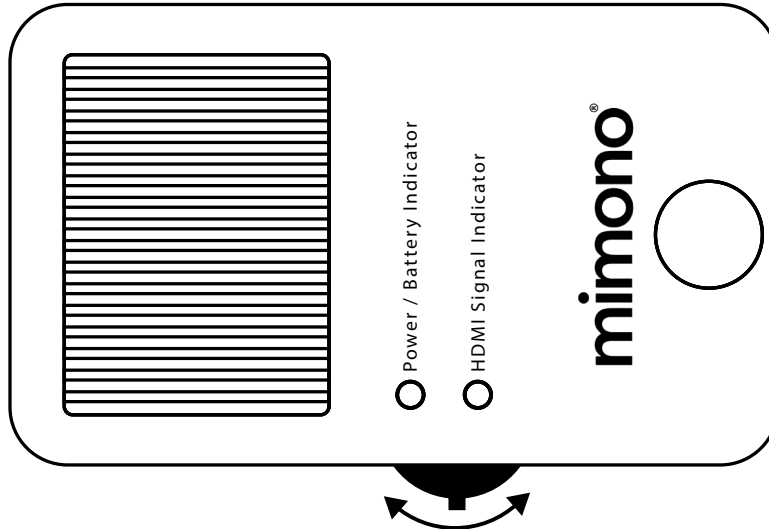

Move the lever (up and down) to choose your selection.

## Product Overview

- Before any operation fully charge your projector for 2hrs
- Press the power key on the side for 4 seconds to power on/off
- In the menu, please adjust projector to factory settings and adjust the sharpness function. While shipped it might of shifted and diss-aligned the laser. Totally normal.
- When not connected to a source, Mimono's smart battery will automatically shut off the unit after 1 minute to lengthen battery life.

## LED Indicator

LED INDICATOR	DESCRIPTION
Power LED Indicator remains on. (When not charging)	Green/Yellow/Red light indicates the remaining battery percentage.
Power LED Indicator flashes (When charging)	The projector is charging. The LED indicator color varies depending on the power status. Note: It will stay solid green when charged to 90%.
HDMI LED Indicator stays on	Signal is detected and connected.
HDMI LED Indicator flashes (When NOT charging)	Function abnormal. Please contact <a href="http://www.mimono.com">www.mimono.com</a>

**Note:** When [charge required] message pops up, the projector has 10% of battery or less. Use USB-C port to charge. If not charged, mimono will automatically shut down.

For more information visit our website:

[www.mimono.com](http://www.mimono.com)



# On-Screen Display (OSD) Function Lever

**Note:** Press the lever into the projector until menu appears on projection.

Mode	Operation
OSD Menu/ Sub-Menu	Press the lever in towards projector for 2 seconds to access the menu
	<ol style="list-style-type: none"> <li>1. Slide the lever forwards or backwards to choose desired function and press the lever in to choose a action.</li> <li>2. To save changes please press the save box</li> <li>3. Press the lever for 3 seconds to exit menu and return to display mode.</li> </ol>

MAIN MENU	
KEYSTONE	Allows for manual screen shape manipulation
FLIP	Allows manual flip of screen
BRIGHTNESS	Sets the brightness of your screen
SHARPNESS	Perfects the images sharpness
GREEN 1 ALIGNMENT	Allows dimming or strengthening of green tube
GREEN 2 ALIGNMENT	Allows dimming or strengthening of green tube
RED 1 ALIGNMENT	Allows dimming or strengthening of red tube
RED 2 ALIGNMENT	Allows dimming or strengthening of red tube
LANGUAGE	Set language
FACTORY SETTING	Return to factory proposed settings

For more information visit our website:

[www.mimono.com](http://www.mimono.com)





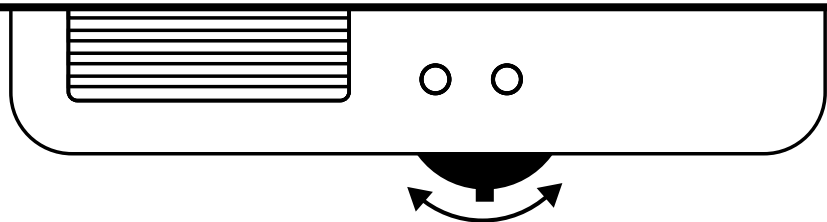

Move the lever (up and down) to choose and press to select or save

# On-Screen Display (OSD) Function Lever



ICON	Description
Save	Press this icon every time changes are made in menu
Scroll up/down	To choose function
Return to main menu	To go back to main menu

Note: After any adjustments in menu, remember to press the save icon, or settings will NOT save.

## KEYSTONE (Projection screen shape correction)

Although mimono has automatic keystone correction, it can be manipulated manually with this option. If there is no perpendicular alignment between the wall and the projector, the image will look like a trapezoid. When this happens you can correct it to a square with this function.

**Note:** For the automatic keystone correction to function correctly, mimono must be in a still position.

## FLIP (Screen Flip)

Mimono has automatic screen flip when turned upside down and set into a still position. If not set into a still position, it will not be able to flip.

## BRIGHTNESS

Slide lever up and down to adjust brightness.

## SHARPNESS

When the projected image is blurred or overlapped, use the arrows to adjust and align the image. Then press the save icon.

## GREEN 1 / GREEN 2 / RED 1 / RED 2 / ALIGNMENTS

For correction and manipulation of projected colors. When adjusting, notice the color change of the checkerboard image's edge. When there is no obvious color difference, please save the setting and go to the next alignment to adjust as needed.

For more information visit our website:

[www.mimono.com](http://www.mimono.com)



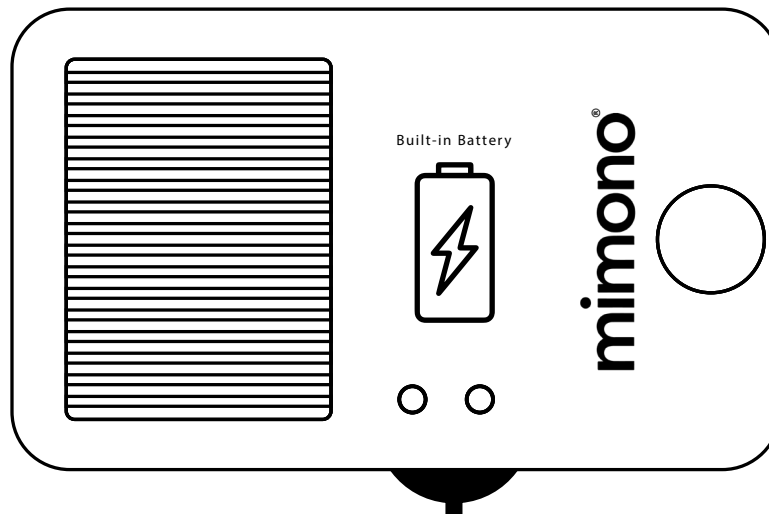

## Built-in Battery

### Connecting to Power

Use the USB type C cable to connect the USB type C jack on the opposite side of the lens of the projector to a (5V / 2.5A) power adapter or power bank.

**Note: First time using the battery in mimono projector, please charge for 3 hours without interruption and with projector off. It is recommended NOT to use a computer as a source of power for this first charge, it might not be enough power.**

### Using the Battery

1. When fully charged the battery will power the projector for 4 hours.
2. Regular charging time using a 5V/2.5A power supply is approx. 2 hours to be fully charged. (While the projector is off).
3. Charging the projector (while it's on and operating) with a 5V/2.5A power source will take approximately 3 hours. For faster charge, turn the projector off.

**Note: Using the mimono while charging - The power supply must meet the 2.5A rating or the projector will shut down since it needs a certain charging rate to operate and charge at the same time.**

For more information visit our website:

[www.mimono.com](http://www.mimono.com)

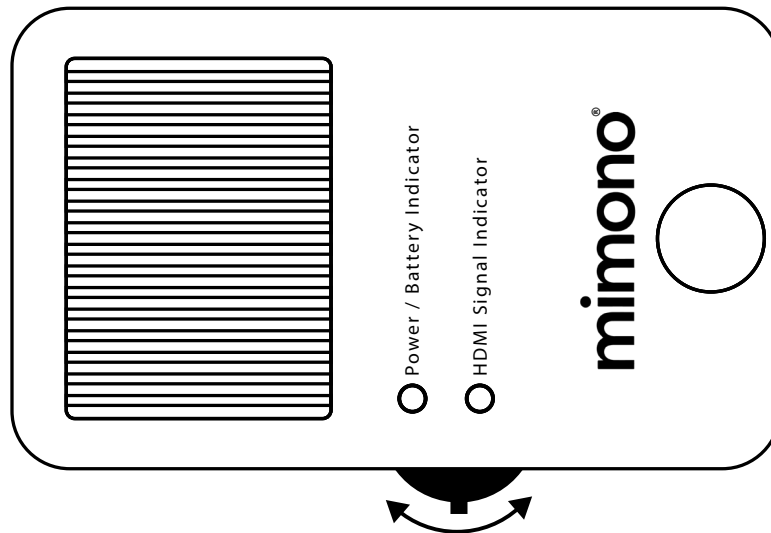

Move the lever (up and down) to choose your selection.

## Battery Capacity Indicator

Power LED Indicator	Remaining Battery %
Green Light	70% to 100% battery remaining
Yellow Light	30% to 69% battery remaining
Red Light	1% to 10% battery remaining

1. When charging, Power LED indicator flashes until solid green, meaning it is 90% charged.
2. When projecting and [LOW BATTERY] message pops up, use usb Type C cable to charge. This indicates you have 10% of the battery remaining. If the projector keeps operating without charge, it will shut down automatically.
3. The USB Type C port of the projector does not support charging of other devices. Power LED Indicator Remaining Battery % Green Light 70% to 100% battery remaining Yellow Light 30% to 69% battery remaining Red Light 1% to 10% battery remaining 10

For more information visit our website:

[www.mimono.com](http://www.mimono.com)



# Specifications

Category	Specifications
Model #	Model # HD-501M
Technology	MEMS 2D Laser Scanning Input (max) 1920x1080 Full HD
Resolution	Output: 1280 x 720p HD
Brightness	120 lumens to the eye
Contrast Ratio 80,000 : 1	80,000 : 1
Color Gamut >150%	>150%
Throw Ratio	: 1.37
Focus Focus free	Focus free
Light Source	5 channel laser diodes
Dimensions	Full body(H 10.5in x W 3.2in x L 4.7in) (H 27cm x W 8.5cm x L 12cm)
Weight	420g / 15oz
Battery Capacity	4000 mAh
Input	HDMI
Power Input	DC 5V/2.5A
Operating Temperature	0° C to 35° C (32°F to 95°F)

For more information visit our website:

[www.mimono.com](http://www.mimono.com)

Problem	Solution
No images are projected (HDMI LED Indicator OFF)	<ol style="list-style-type: none"> <li>1. Ensure HDMI cable is connected properly into the HDMI input.</li> <li>2. Check the video source is sending the content to the projector.</li> </ol>
No images are projected (HDMI LED Indicator ON)	Reset the projector pressing the reset button (3 sec.) on side of projector and restart.
Instant image loss	Reset the projector pressing the reset button (3 sec.) on side of projector and restart.
The color does not look appropriate	<ol style="list-style-type: none"> <li>1. Check the video source for any abnormalities.</li> <li>2. Power off and restart projector</li> <li>3. Go to the main menu / settings then adjust color tubes and save at the end.</li> </ol>
Jitter in image	<ol style="list-style-type: none"> <li>1. Power off and restart the projector.</li> <li>2. Keep metallic and magnetic materials away from the projector. Power off and restart.</li> <li>3. Check if there is any source of vibration such as speakers.</li> </ol>
The image is flickering or blurred	Hold the lever on the side to access the menu. Go to [sharpness] and adjust. Press the save icon at the end to save changes.
Unexpected frame color (green, red or blue) shown in the margin of the left / right side of the display word.	Hold down the lever on side of projector for 3 seconds to enter the main menu. Then adjust Green1, Green2, Red1, Red2, Alignment to adjust.
Partial area blurred or color fringing appeared in the display	Check lens, and clean with damp soft clean cloth.
Other abnormal status of projected image	Turn off and power back on. If problem persists, reset the projector, with the reset button on side.
Their is no sound	Check the audio/video source, mimono does not have speakers.

For more information visit our website:

[www.mimono.com](http://www.mimono.com)



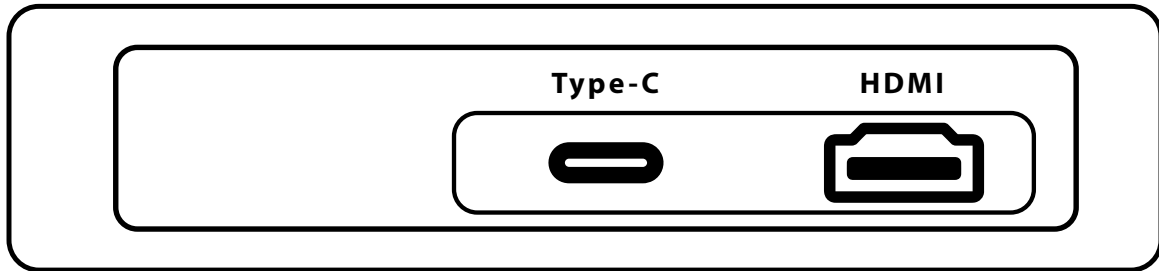
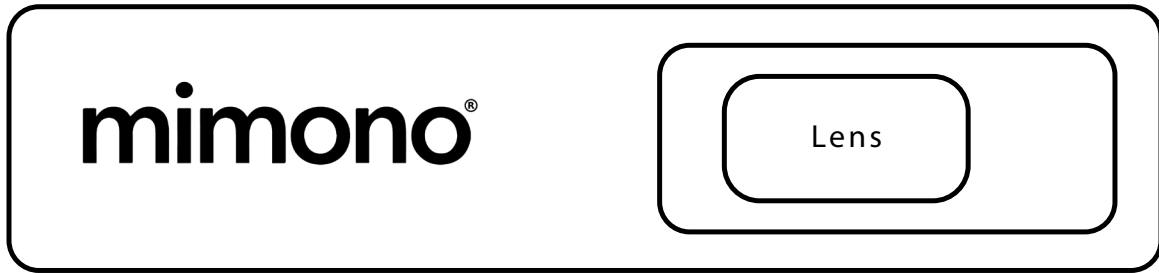

## Maintenance and Precautions

At all times keep projector free of dust and debris. Do not pour or spray any liquids on the projector.

### Cleaning the Lens

1. Use canister of compressed air to remove dust or dirt from the projector.
2. If lens is still not clean, use lens cleaning cloth. Or moisten a soft cloth with lens cleaner and gently wipe the surface. Never rub the lens with any other materials.

### Cleaning the Case

1. Use a soft lint-free dry cloth to remove dirt or dust.
2. If the case is still not clean, please use a clean and soft lint-free cloth to apply a small amount of computer cleaner or a water dampened cloth to wipe surface

### Caution:

Never use wax, benzene, ammonia, alcohol or any other chemical detergents to clean or wipe the projector

For more information visit our website:

[www.mimono.com](http://www.mimono.com)